

CERTApLank[®]

Single 7" Reinforced Siding Installation Instructions

CERTApLank Single 7" Reinforced Siding is a rigid, foam-backed panel that uses standard 3/4" accessories. Key points to note about to how to properly install CERTApLank:

TOP POINTS TO REMEMBER:

1. Use CERTApLank starter strip.
2. Each panel must have one end trimmed prior to lapping.
3. Each panel must be center pinned.
4. DO NOT butt foam edges when installing panels.

Preparing Wall Surfaces

The key to successful vinyl siding application is proper preparation of the nailing surface. CERTApLank panels must be installed over a smooth, solid substrate with nail holding strength such as plywood, oriented strand board or existing wood siding (minimum 7/16" thick). The more level and even the wall surface, the better the finished installation will look.

The steps involved in preparation differ for new construction versus remodel homes, so choose the instructions that pertain to your project. All weatherproofing needs completion prior to siding installation. Like all other vinyl siding, CERTApLank siding is not water tight.

Starter Strips

CERTApLank uses a specially designed CERTApLank starter strip to accommodate the foam and offset butt section.

An alternative method of starting CERTApLank is to use 3/4" J-Channel in place of starter strip to receive the bottom edge of the panel.

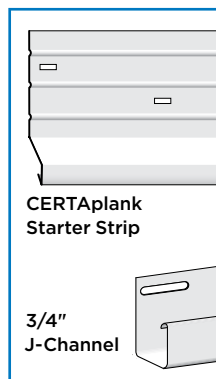

Trimming the Factory End for Overlap

CERTApLank panels come with foam that is set back from both ends of the panel. **Prior to lapping panels, the factory end of the underlapping panel must be removed.** The underlapping panel **MUST** be trimmed at least 1-1/2". Overlapping panels **MUST** always utilize a factory end.

Example: When installing left-to-right, the right end of each panel at an overlap will need to be trimmed 1-1/2" prior to installation.

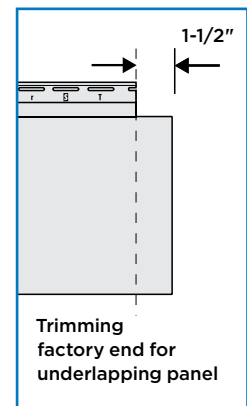

ProTips™: Cuts are best made with a chop saw or snips.

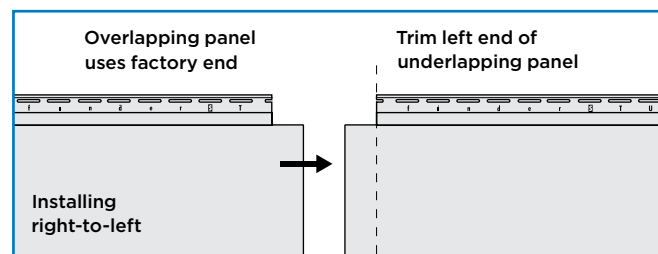
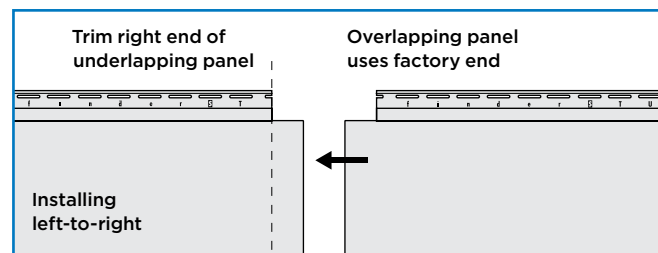

Fastening

Use 1-1/2" (minimum) corrosion-resistant nails to penetrate solid framing (such as wood sheathing and studs) at least 1-1/4". Drive the nails until there is 1/16" to 1/8" between the nail head and the nail flange. (Also see "Nail Spacing and Product Expansion and Contraction" chart below).

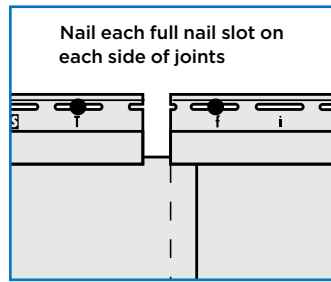

Detail of CERTAplank Overlap (note nailing on both sides)

Position nails in the center of the nail slots. Nail spacing is 16" on center. **Also, nail in the center of the last available full nail slot above each side of a lap joint** to help control panel movement. Do not hard nail these fasteners. **Fasteners at lap joint do not need to penetrate a stud.**

Center Pinning

CERTAplank Reinforced Siding differs from other foam-backed siding installation. Center pinning the panel is required to control expansion and contraction at the overlap.

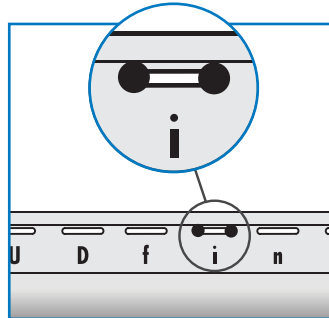

Locate the center of the panel. Center pin the panel in this location by installing a nail on both ends of the same nail slot. **Center pin fasteners do not need to penetrate a stud.**

Important: Center pin each panel regardless of length.

NOTE: Do not drive center-pin nails tight. Leave 1/16" to 1/8" between the nail head and the panel to allow the panel to move freely during normal expansion and contraction.

Overlapping Panels

For CERTAplank, slide the panels together until you achieve an overlap of 1" for temperatures over 40°F. When temperature is under 40°F, overlap panels 3/4".

NOTE: Do not butt foam edges when installing panels. Foam is not designed to be butted.

ProTips™: Lap away from the highest traffic pattern, typically the front of the house. Keep laps at least 3' apart from course to course. Separate joints by at least 2 courses.

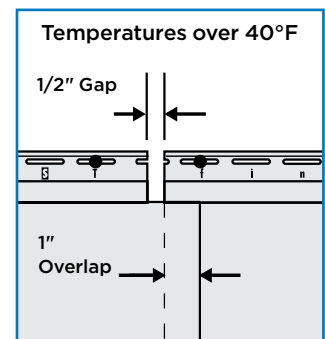
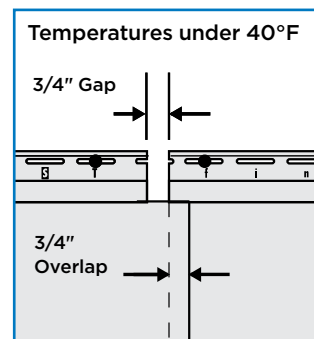
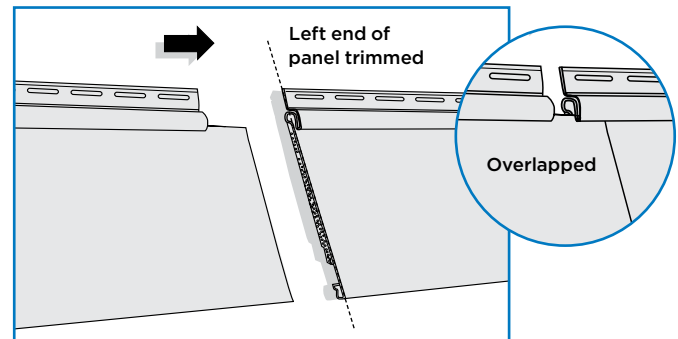

Nail Spacing and Product Expansion and Contraction

Product Category	Max. Nail Spacing	Gaps to Accessories		Overlap	
		40°F or Greater	Less than 40° F	40° F or Greater	Less than 40° F
CERTAplank	16"	1/4"	3/8"	1"	3/4"

STUDfinder Installation System

The STUDfinder™ Installation System combines precisely engineered nail slot locations with graphics to create a siding panel that is designed to help ensure quick, accurate and secure installation. The nail slots are positioned 16" on center to allow for alignment with studs, with STUDfinder graphics centered directly under each nail slot.

Locate the first stud and fasten in the center of the nail slot. Ensure that nail penetration is at least 1-1/4" into framing members to comply with ASTM D4756 (specification for vinyl siding installation). Notice which STUDfinder letter appears below the slot.

Go to the next repeat of the letter to find the next stud. For example, if your first stud is at "T," so will the succeeding studs in 16" o.c. applications (every 10th slot).

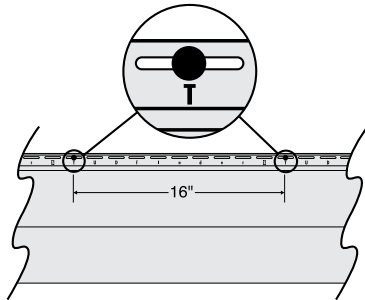

NOTE: CERTAplank panels must overlap 3/4" to 1". Consequently, the overlapping panels may not use the same letter as your initial panel.

Fitting into Trim Pieces

Around windows, doors, and other openings, use standard 3/4" accessories. Standard vinyl installation rules apply. When the outside temperature is higher than 40°F, allow a 1/4" gap between the siding and the trim. When the temperature is less than 40°F, leave a 3/8" gap.

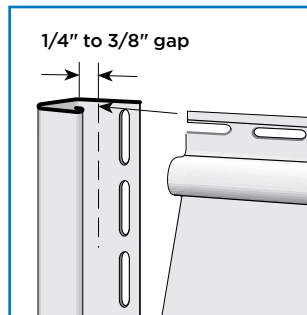

ProTips™: When installing CERTAplank siding, you may need to angle the panel slightly towards you to help fully engage the interlock.

Finishing the Last Course

Secure the last course of siding under the soffit with 3/8" J-Channel, Undersill Trim or Cornice Molding.

Finishing with 3/8" J-Channel

To finish the top course of CERTAplank with 3/8" J-Channel, use a snap lock punch through the panel and foam to raise tabs every 6" to lock the panels into the J-Channel.

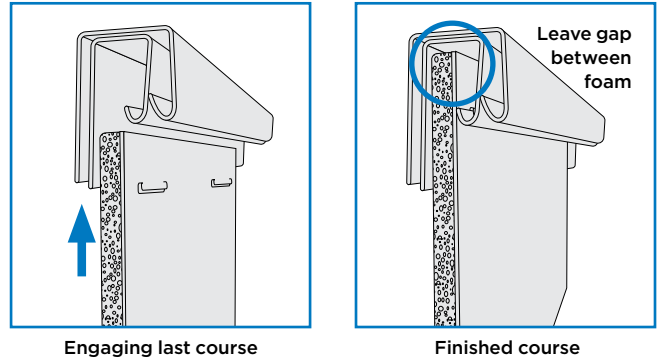

Finishing with Undersill Trim

To finish the top course of CERTAplank with undersill trim, shim the trim to accommodate the thickness of the siding panel. Remove the top 1-1/2" of the foam backing so the top of the panel fits into shimmed trim. Use a snap lock punch to raise tabs every 6" to lock the panels into the trim.

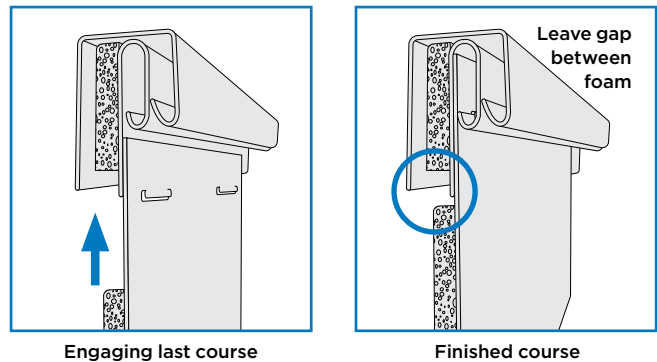

Finishing with Cornice Molding

To finish the top course of CERTAplank, attach cornice receiver to the top of the wall under the eave or soffit. Trim the top panel to within 1/4" of the cornice receiver. Using a nail slot punch, punch nail slots through the panel and foam 1/4" from the trimmed edge of the siding panel, 16" apart. Nail off the top course and remember to center pin the panel. Snap the cornice molding into the cornice receiver.

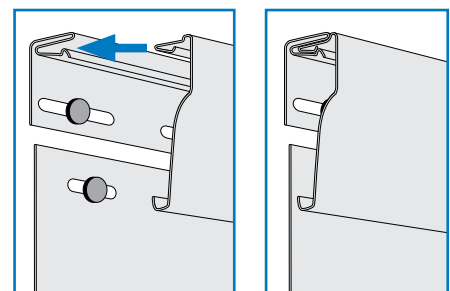



CertainTeed

CEILINGS • DECKING • FENCE • GYPSUM • INSULATION • RAILING • ROOFING • SIDING • TRIM
20 Moores Road, Malvern, PA 19355 Professional: 800-233-8990 Consumer: 800-782-8777 certainteed.com